

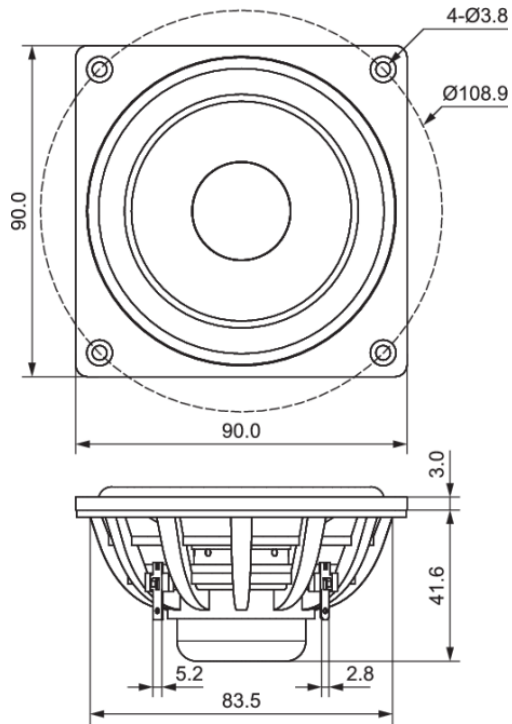

DMA90-4 3-1/2" Dual Magnet Aluminum Cone Full-Range Driver 4 Ohm



PARAMETERS

Impedance	4 ohms
Re	3.8 ohms
Le	0.3 mH @ 1 kHz
Fs	88.2 Hz
Qms	2.50
Qes	0.56
Qts	0.45
Mms	3.2 g
Cms	1.03 mm/N
Sd	38.5 cm ²
Vd	9.6 cm ³
BL	3.5 Tm
Vas	0.08 ft ³
Xmax	2.5 mm
VC Diameter	1"
SPL	89.3 dB @ 2.83V/1m
RMS Power Handling	30 watts
Usable Frequency Range (Hz)	85-20,000 Hz

FEATURES

- Excellent high frequency response for true full-range applications
- Dual neodymium motor to create a symmetrical magnetic field for superb control
- Large copper cap lowers distortion while improving high frequency response
- Vented aluminum voice coil former with exceptional heat dissipation for high power handling
- Exclusive 12-spoke open frame design provides extensive venting and minimal reflection
- DIY friendly, oversized mounting flange makes installation simple
- Matching tunable passive radiators also available!

IMPEDANCE/PHASE



FREQUENCY RESPONSE

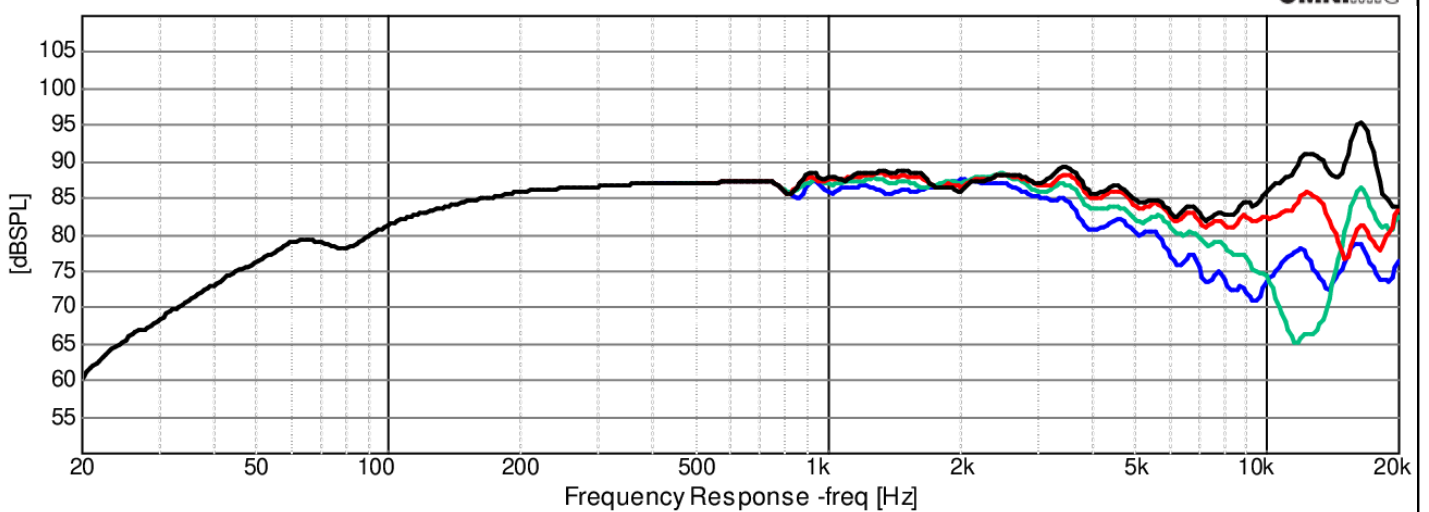

OmniMic

Note: 1/24th octave smoothing - nearfield response included in graph below 450 Hz.

Black = 0°
Red = 15°
Green = 30°
Blue = 45°